

L-3 TRL LOCATION MAP

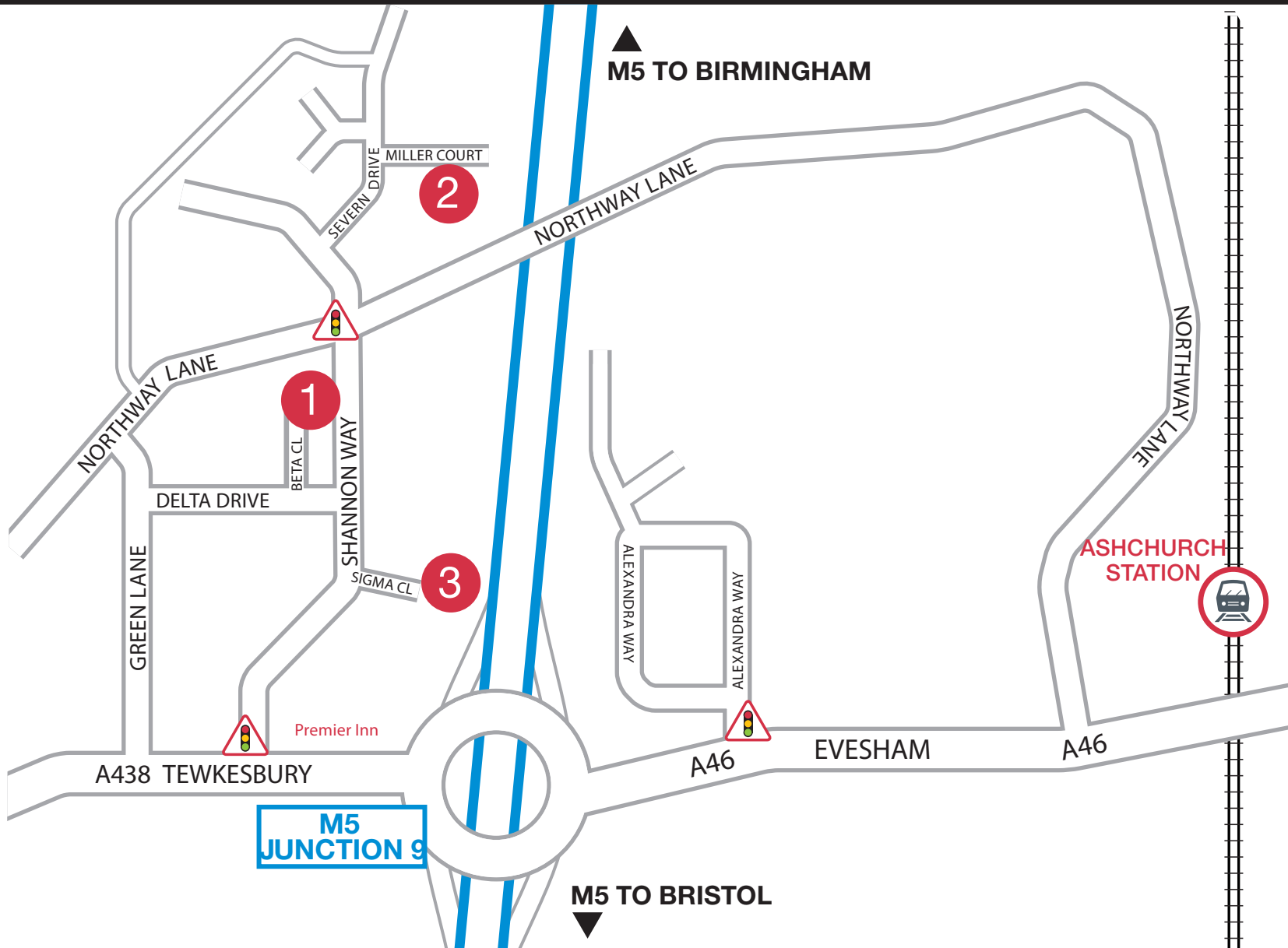

- 1 Head Office**
11/12 Shannon Way
- 2 Unit 19**
Miller Court
- 3 Sigma Close**

Ashchurch Station (for Tewkesbury)

Train services for
Birmingham, Nottingham,
South Wales and Bristol.

For train times and fare
information contact
National Rail Enquiries
on 08457 48 49 50.

Head Office

11 Shannon Way, Tewkesbury, Gloucestershire GL20 8ND

Tel: +44 (0) 1684 278 700 Fax: +44 (0) 1684 850 406 Email: info.trl@L-3Com.com

Deliveries: 11 Shannon Way (via Delta Drive)

FOR ALL VISITORS TO L-3 TRL

Personal Electronic Devices (PEDs) are prohibited, which include but are not limited to:

- **Smart Devices (inc. tablets, phablets & wearable technology)**
- **Mobile Phones**
- **Laptops (of any kind)**
- **Cameras**
- **Camcorders**
- **Dictaphones**
- **E-Readers**
- **iPods**
- **USBs**

Please leave these items in your car or in the red lockers provided in reception for secure storage.

Phones must be switched off if left in lockers.

If there is a valid requirement for these items to be brought on site, then permission must be granted from Security.